

INDEX	SAS000919
REV. LEVEL	1
SHEET	1 OF 1

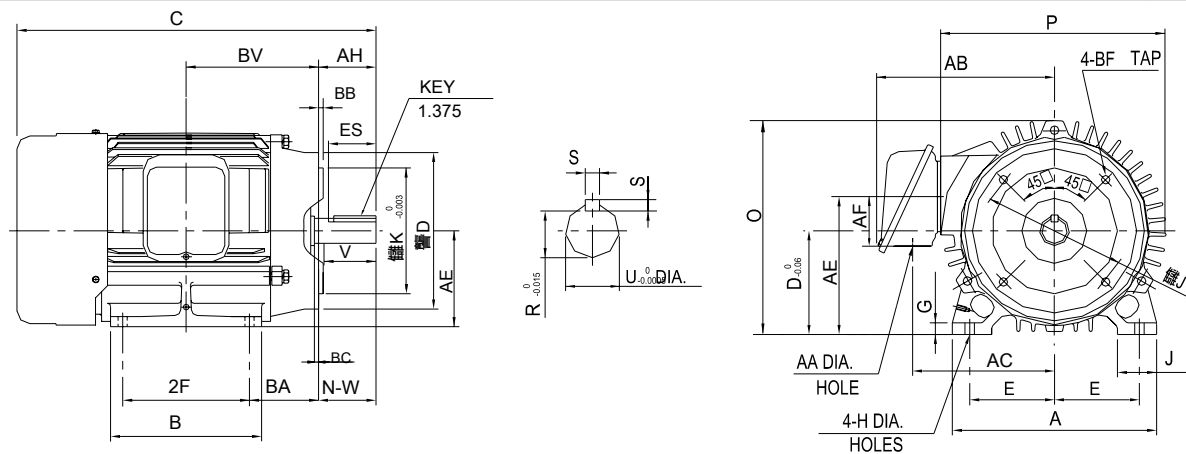

UNITS: INCHES

FRAME SIZE	MOUNTING				FLANGE							
	E	2F	H	BA	AH	AJ	AK	BB	BC	BD	BF TAP	BV
143TC	2.75	4.00	0.34	2.25	2.12	5.875	4.50	0.16	0.12	6.50	3/8-16	4.38
145TC	2.75	5.00	0.34	2.25	2.12	5.875	4.50	0.16	0.12	6.50	3/8-16	4.38

FRAME SIZE	MOTOR DIMENSIONS								CONDUIT BOX						
	A	B	C	D	G	J	O	P	AA	AB	AC	AE	AF	XL	XN
143TC	6.93	4.88	12.41	3.5	0.35	1.57	7.57	8.15	0.866	6.57	5.28	4.68	0.43	—	—
145TC	6.93	5.87	13.40	3.5	0.35	1.57	7.57	8.15	0.866	6.57	5.28	4.68	0.43	—	—

FRAME SIZE	SHAFT EXTENSION			KEY SEAT			BEARINGS		MAXIMUM WEIGHT
	N-W	V	U	R	S	ES	LS	OS	
143TC/145TC	2.25	2.2	0.875	0.771	0.188	1.375	6205ZZ	6205ZZ	50 lbs.

NOTES:

1. DIMENSION V REPRESENTS LENGTH OF STRAIGHT PART OF SHAFT.
2. CONDUIT BOX MAY BE ROTATED IN 90° INCREMENTS AND MAY BE MOUNTED ON OPPOSITE SIDE ON SPECIAL ORDER.
3. KEY DIMENSIONS EQUAL S x S x 1.375 (MOTOR SUPPLIED WITH KEY)
4. MOTOR WEIGHT SHOWN IS MAXIMUM HORSEPOWER IN FRAME.

ALL DATA SUBJECT TO CHANGE WITHOUT NOTICE FOR CONSTRUCTION USE ONLY CERTIFIED DATA

CERTIFIED DATA

CUSTOMER: _____ P.O. NO.: _____ TAG NO.: _____
 MOTOR MODEL NO.: _____ TOSHIBA FILE NO.: _____
 HP: _____ RPM (SYN.): _____ VOLTAGE: _____ Hz: _____
 FRAME SIZE: _____ LOG NO.: _____ LOG REV. LEVEL: _____
 REMARKS: _____
 PER: _____ ISSUE DATE: _____ SUPERSEDES: _____

TOSHIBA/HOUSTON
TOTALLY-ENCLOSED FAN-COOLED FOOT-MOUNTED WITH C-FACE FLANGE Fr. 143TC-145TC
SAS-000919