

INDEX	SAS000898
REV. LEVEL	2
SHEET	1 OF 1

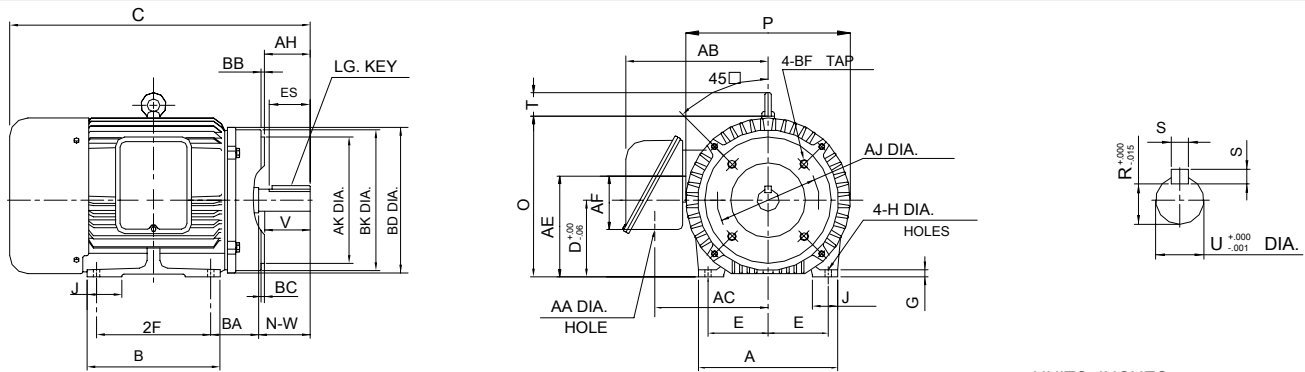

UNITS: INCHES

FRAME SIZE	MOUNTING				FLANGE						
	E	2F	H	BA	AJ	AK	BB	BC	BD	BF TAP	BV
324TC/324TSC	6.25	10.5	0.66	5.25	11.000	12.500	0.25	0.25	17.75	5/8"-11UNC	—
326TC/326TSC	6.25	12.0	0.66	5.25	11.000	12.500	0.25	0.25	17.75	5/8"-11UNC	—

FRAME SIZE	MOTOR DIMENSIONS									CONDUIT BOX						
	A	B	C	D	G	J	O	T	P	AA	AB	AC	AE	AF	XL	XN
324TC	14.88	12.68	29.7	8.00	0.91	3.15	16.90	2.7	17.75	2.48	14.37	12	10.95	5.51	—	—
324TSC	14.88	12.68	26.32	8.00	0.91	3.15	16.90	2.7	17.75	2.48	14.37	12	10.95	5.51	—	—
326TC	14.88	14.17	31.32	8.00	0.91	3.15	16.90	2.7	17.75	2.48	14.37	12	10.95	5.51	—	—
326TSC	14.88	14.17	27.82	8.00	0.91	3.15	16.90	2.7	17.75	2.48	14.37	12	10.95	5.51	—	—

- NOTES:
1. DIMENSION V REPRESENTS LENGTH OF STRAIGHT PART OF SHAFT.
 2. CONDUIT BOX MAY BE ROTATED IN 90° INCREMENTS AND MAY BE MOUNTED ON OPPOSITE SIDE ON SPECIAL ORDER.
 3. "T" KEY DIMENSIONS EQUAL S x S x 3.88
"TS" KEY DIMENSIONS EQUAL S x S x 2.00 (MOTOR SUPPLIED WITH KEY)
 4. MOTOR WEIGHT SHOWN IS MAXIMUM HORSEPOWER IN FRAME.

FRAME SIZE	SHAFT EXTENSION				KEY SEAT			BEARINGS		MAXIMUM WEIGHT
	AH	N-W	V	U	R	S	ES	LS	OS	
324TC/326TC	5.00	5.25	5.00	2.125	1.845	0.500	3.91	6312	6212	593 lbs.
324TSC/326TSC	3.50	3.75	3.50	1.875	1.591	0.500	2.03	6312C3	6212C3	514 lbs.

ALL DATA SUBJECT TO CHANGE WITHOUT NOTICE FOR CONSTRUCTION USE ONLY CERTIFIED DATA

CERTIFIED DATA

CUSTOMER: _____ P.O. NO.: _____ TAG NO.: _____
MOTOR MODEL NO.: _____ TOSHIBA FILE NO.: _____
HP: _____ RPM (SYN.): _____ VOLTAGE: _____ Hz: _____
FRAME SIZE: _____ LOG NO.: _____ LOG REV. LEVEL: _____
REMARKS: _____
PER: _____ ISSUE DATE: _____ SUPERSEDES: _____

TOSHIBA/HOUSTON

**TOTALLY-ENCLOSED
FAN-COOLED
FOOT-MOUNTED
WITH C-FACE FLANGE
Fr. 324TC-326TC
Fr. 324TSC-326TSC**

SAS000898